

**Edge Weight
for paper backgrounds**

Art. No. F004394

Quickstart Guide

Delivery content:

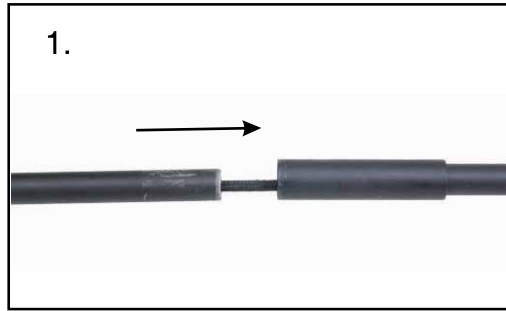

Connect 3 section of steel tubes by inserting them to each other. The tubes are spring loaded in-series. The length should be about 2.8 meters.



Fold the background paper backside up and prepare to use the double adhesive tape to tape onto the paper edge.

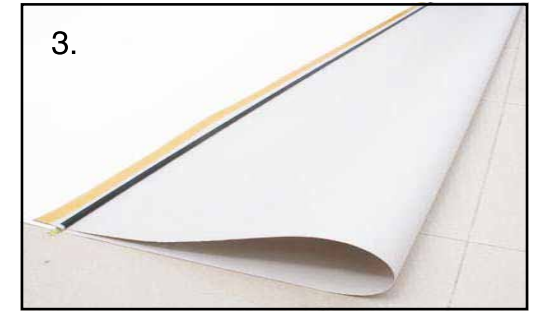

Put the steel rod onto the paper about 30 mm from the paper edge. Then stick the double side tape onto the paper edge from one end to other. Do not peel off the tape backing yet.

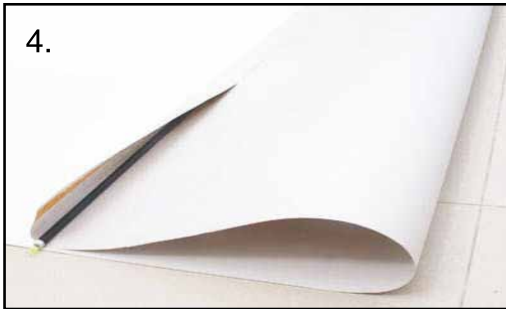

Fold the paper edge to form a 50 mm pocket with the steel rod in. The paper has to be folded 180 degrees so it has a folding line. Then peel off the tape backing and stick the paper edge to form a hem.

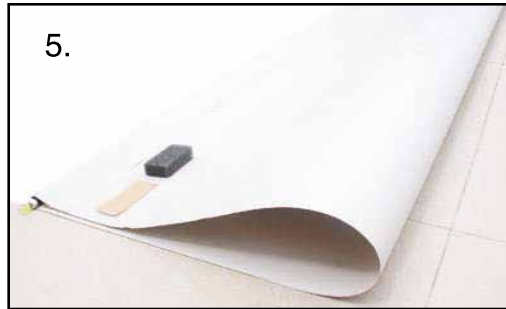

Soak sponge in water and squeeze off excessive water. Moisten the paper tape. Use 4 tapes, one at each end and two in the middle, about one meter apart.

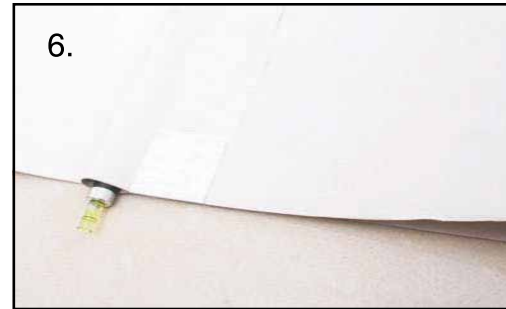

Once the paper tape is in place, it will hold up the hem more securely. Do not over wet the paper tape as it will not stick and also damage the background paper.

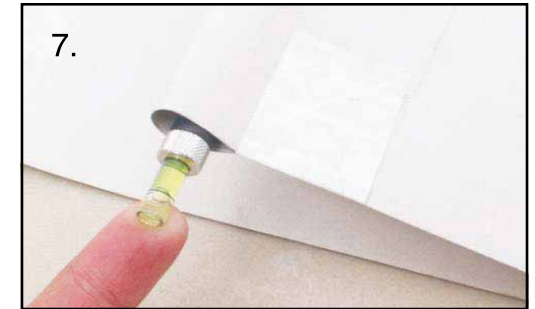

The bubble level

